

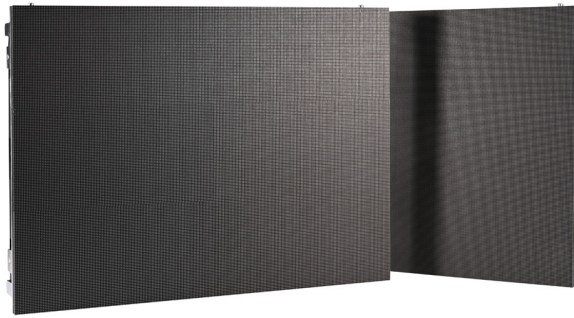

**VWX-COB-FPP**

Fine Pitch LED DISPLAY



Free & Seamless  
Splicing



Ultrahigh  
Refresh Rate



Wide  
Viewing Angle



Quick  
Response Time



More  
Color Depth



Wide  
Color Gamut



Superior  
Contrast Ratio

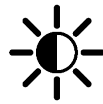

High Brightness



Excellent  
Heat Dissipation

VWX-COB-FPP is a cost effective indoor fine pitch LED display with cabinet aspect ratio of 16:9. NX adopts adjustable connector to minimize the use of cables for more stable and better performance. The popular cabinet size are widely used in the LED display market, it can fulfil various scenarios. NX comes with high refresh rate, high contrast ratio and wide viewing angle. This series is full front maintenance with long LED lifetime. It's definitely the quality product for money.

**DIMENSIONS IN MM, 600 x 337.5 x 37.4 mm, 4.1 kg**

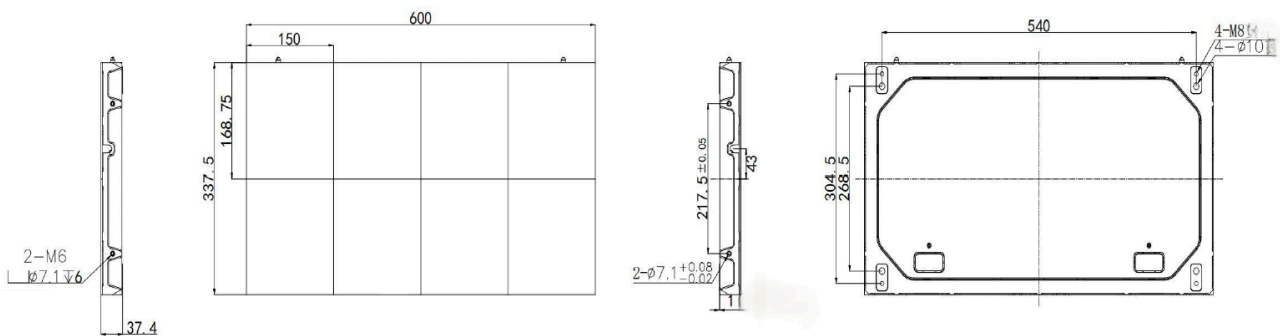

VWX-COB-FPP		
Physical Parameter	Pixel Pitch	1.25 mm
	LED Type	Full-Flip-Chip COB
	Pixel Density (m <sup>2</sup> )	640,000 pixels/m <sup>2</sup>
	Pixel Density (Cabinet)	129,600 pixels/cabinet
	Resolution of LED Module (W × H)	120 x 135 pixels
	Resolution of Cabinet (W × H)	480 x 270 pixels
	LED Module Size(W × H)	150 x 168.75 mm
	Cabinet Size (W × H × D)	600 x 337.5 x 37.3 mm   27 in
	No. of Modules Per Cabinet(W × H)	4 x 2
	Cabinet Area	0.2025 m <sup>2</sup>
	Aspect Ratio	16:9
	Weight (per cabinet)	4.1 kg
	Cabinet Material	Die-casting Aluminium
Optical Parameter	Brightness	≥600nits
	Max Contrast Ratio	5000 : 1
	Horizontal Viewing Angle	≥165°
	Vertical Viewing Angle	≥165°
	Scan Rate(Common Anode)	60
	Color Temperature - Adjustable	3000~10000K
Electrical Parameter	Average Power Consumption(W/ m <sup>2</sup> )	≤98
	Max Power Consumption(W/m <sup>2</sup> )	≤295
	Input Power Voltage	AC110~220±15%V
Processing Parameter	Drive Mode	Constant Current Common Anode
	Frame Rate	60 Hz
	Refresh Rate	≥3840 Hz
	Gray Scale Processing	14 bit
Operation Conditions	Operating Temp/Humidity	-10 - 40°C/ 10% - 90%RH
	Storage Temp/Humidity	-40 - 60 °C/ 10% - 60%RH
	IP Rating	IP65 Module Surface ONLY
	Life span, typ.	100,000 Hrs
Service	Servicing	Front
Certification	Certification	CE, CB

*\*Product information is subject to change without prior notice.*

